

ACCU-CHEK[®] Compact Plus

BLOEDGLUCOSEMETER

Beknopte
gebruiks-
aanwijzing

 Deze beknopte gebruiksaanwijzing is geen vervanging van de gebruiksaanwijzing van uw Accu-Chek Compact Plus-bloedglucosemeter. De veiligheidsaanwijzingen in de gebruiksaanwijzing dienen absoluut te worden opgevolgd!

1. Teststrokcassette plaatsen of vervangen

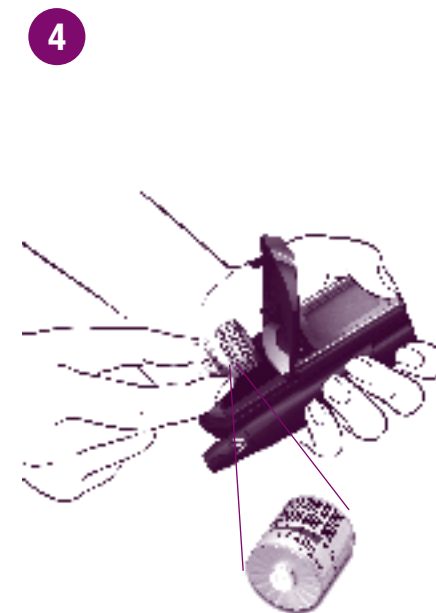

2. Prikpen voorbereiden

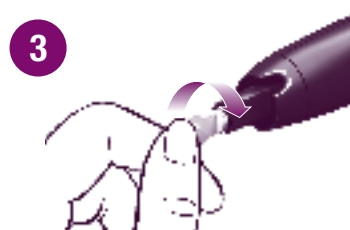

ACCU-CHEK and SOFTCLIX are trademarks of a Member of the Roche Group.

 Roche Diagnostics GmbH
D-68298 Mannheim
Germany
www.accu-chek.com

0 4573056001(01) 01/05

3. Uitvoeren van een bloed-glucosemeting

1

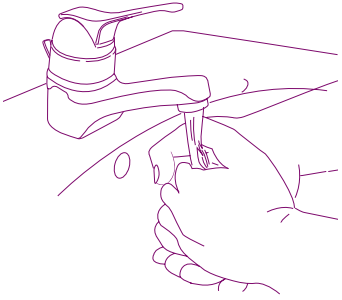

2



3



4



5

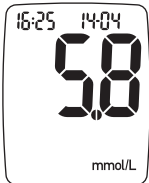
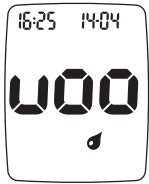
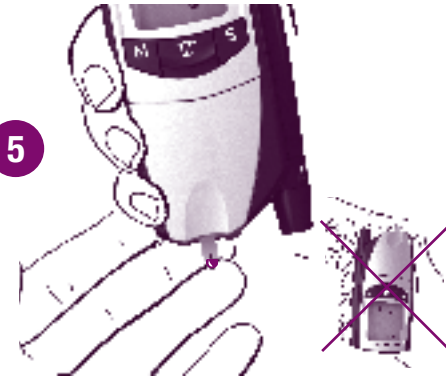

6



7



8

