

Accu-Chek® Mobile – Measure your blood glucose whenever and wherever you want.

Measuring in 4 easy steps



Opening
Open the tip protector.
The measuring device switches on.



Taking a blood sample
Press the lancing device firmly against the side of your finger tip. Now press the release button down all the way: only 1 click for setting and release.



Measuring
Apply the drop of blood to the center of the test field. Only touch the test field lightly.



Closing
You can read the result after approximately 5 seconds. When you close the tip protector, the measuring device switches off automatically.

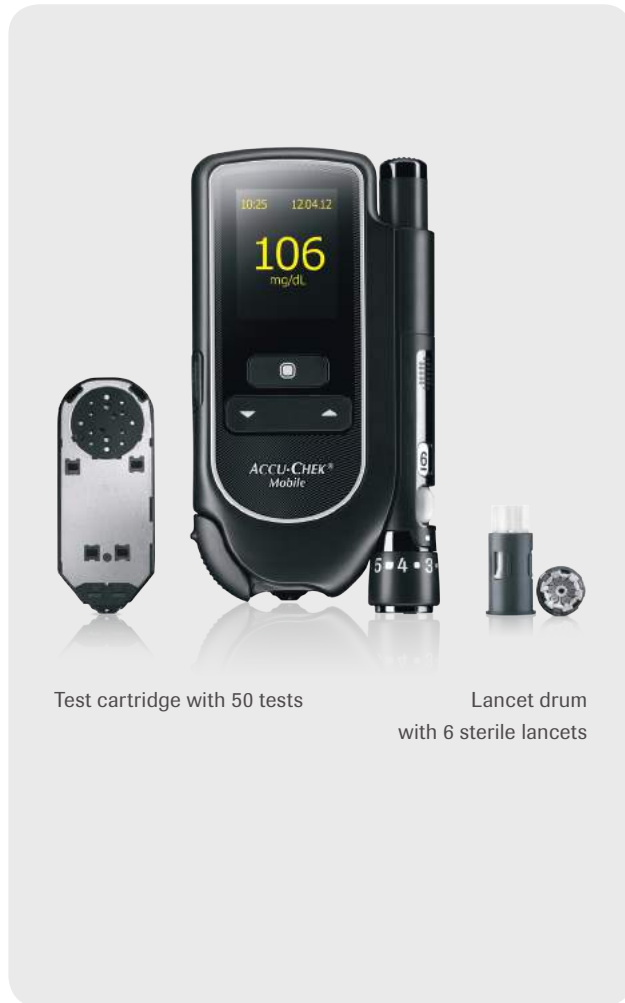

Test cartridge with 50 tests

Lancet drum
with 6 sterile lancets

Set-up / Changing the test cartridge (1-3)



Open the tip protector to the stop. Only then can you open the cartridge compartment and insert the test cartridge.



Push the locking button of the cartridge compartment lid upwards.



Insert a new test cartridge into the measuring device. Close the lid of the cartridge compartment and the tip protector.



Pull the protective foil for the batteries from the measuring device in backward direction. Pull the protective foil from the display.

Preparation of a lancet



Prepare the lancing device for the next blood sample: move the lever in direction ① and back again in direction ②.



Rotate the cap, until the marking shows the desired penetration depth. Start with a medium penetration depth, i.e. 3.



Only remove the lancet drum after all 6 lancets have been used.



Once a lancet drum has been removed, it cannot be re-inserted. This is indicated by the red stripe.

Changing the lancet drum



Pull the cap from the lancing device.



Remove the lancet drum.

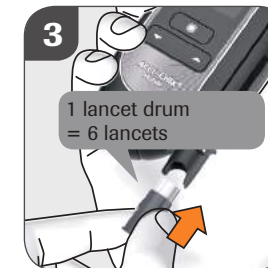

Insert the new lancet drum (white end first). You now have 6 lancets available.



Replace the cap.



www.accu-check.de
 Roche Diabetes Care Deutschland GmbH
 Sandhofer Straße 116
 68305 Mannheim

ACCU-CHEK, ACCU-CHEK MOBILE and FASTCLIX are trademarks of Roche.
 © 2016 Roche Diabetes Care. All rights reserved.

ACCU-CHEK®